



3 YEAR
Limited Warranty

Features and benefits

- Provides the versatility of operating two anchors from one winch.
- Functional rope hauling from any direction using independent MAX-grip™ snag-free warping drum with clutch disengagement of chainwheel for positive control of all ropes.
- Permits use of traditional shackle and thimble rope and chain connection.
- Allows alternative mounting horizontally on a fore and aft bulkhead inside chain locker for below deck installation.
- High-quality finish on above deck components, manufactured from marine grade 316 stainless steel and chromed bronze, for long term durability.
- Cone type brake/clutch mechanism permits manual 'Free Fall' anchoring. Cone clutches, unlike dog clutches, provide smooth progressive engagement ensuring safe operator control.
- Chainwheel locking pawl (except on VW500).
- Simplified through deck installation by modular design and precise alignment of gearbox to the topworks utilising marine-grade stainless steel bolts.
- Anodized aluminium gearbox and spacer on 500, 1000 and 1500 models. Marine-grade alloy gearbox housing, finished with a two coat paint system on 2500 and 3500 models.
- Heavy duty, dual direction motor, designed for marine winches.
- Easily disassembled for servicing.

STANDARD EQUIPMENT REQUIRED FOR SINGLE DIRECTION CONTROL

- Circuit breaker/isolator panel (supplied with DC units only)
- Foot Switches (supplied with DC units only)
- Chainwheel to suit chain sizes specified
- Emergency crank handle and clutch control lever (except on VW500)

OPTIONS

- Up/Down remote control panel
- Additional foot Switches
- Extra deck clearance kit
- Dual direction solenoid pack
- AutoAnchor™ Equipment
- Chain Stopper*
- Hydraulic motor (except on 500)
- Chain Snubber

All standard and optional control accessories can be found on pages 26-29.

SPECIFICATIONS

MODEL	500*	1000	1500	2500	3500
Maximum Pull/Lift	227kg 500lbs	700kg 1540lbs	850kg 1870lbs	1135kg 2500lbs	1590kg 3500lbs
Static Hold	600kg 1320lbs	1500kg 3300lbs	1500kg 3300lbs	2200kg 4840lbs	2200kg 4840lbs
Chain Short Link	6/7mm 1/4"	6-10mm 1/4" -3/8"	6-10mm 1/4" -3/8"	9-11mm 5/16" -3/8"	10-13mm 3/8" -1/2"
Line Speed**	18m/min 59ft/min	18m/min 59ft/min	18m/min 59ft/min	15m/min 50ft/min	10m/min 33ft/min
Power Supply (DC)	12 or 24V	12 or 24V	12 or 24V	12 or 24V	12 or 24V
Motor (Watts)	600W	1000W	1200W	1200W	1200W
Net Weight (Electric)	10kg 22lbs	22kg 50lbs	22kg 50lbs	38kg 84lbs	48kg 105lbs
Hydraulic Pressure	N/A	100bar 1450psi	138bar 2000psi	138bar 2000psi	138bar 2000psi
Hydraulic Flow	N/A	20 l/min 5.3USgal/min	20 l/min 5.3USgal/min	36 l/min 9.5USgal/min	42 l/min 11USgal/min
Net Weight (Hyd)	N/A	15kg 34lbs	15kg 34lbs	32kg 70lbs	40kg 88lbs

* Available USA only.

** Winch performance when hauling rope with capstan. Chain speed may vary depending on size of chain and gypsy.

DIMENSIONS

MODEL	500	1000	1500	2500	3500
A	65mm 2 9/16"	80mm 3 1/8"	80mm 3 1/8"	94mm 3 11/16"	110mm 4 5/16"
B	151mm 6"	198mm 7 3/4"	198mm 7 3/4"	251mm 9 15/16"	276mm 10 7/8"
C	40mm 1 5/8"	59mm 2 3/8"	59mm 2 3/8"	80mm 3 5/32"	83mm 3 9/32"
D	173mm 6 7/8"	252mm 9 15/16"	252mm 9 15/16"	210mm 8 5/15"	210mm 8 5/15"
E	244mm 9 5/8"	272mm 10 23/32"	272mm 10 23/32"	281mm 11 1/8"	281mm 11 1/8"
F	133mm 5 1/4"	165mm 6 1/2"	165mm 6 1/2"	190mm 7 1/2"	270mm 10 5/8"
G (Std deck clearance)**	57mm 2 1/4"	100mm 4"	100mm 4"	100mm 4"	100mm 4"
G (Extra deck clearance) ^	N/A	150mm 6"	150mm 6"	200mm 8"	200mm 8"
I	133mm 5 1/4"	165mm 6 1/2"	165mm 6 1/2"	194mm 7 5/8"	270mm 10 5/8"

**For VW1000 and VW1500 shorter deck clearance version also available at 50mm (2")

^ A deck clearance increase will also increase the 'D' measurement by the same increment.

***Important:** Maxwell windlasses must be used in conjunction with a chain stopper and/or alternative snubbing device to take the load off the windlass while laying at anchor. The chain stopper and alternative snubbing system should also be used to secure the anchor in the fully raised position while under way.

The VW Series of anchor winches are designed for traditional rope and chain combination anchor rodes, where manual transfer of the rode from the rope warping drum to the chainwheel is required

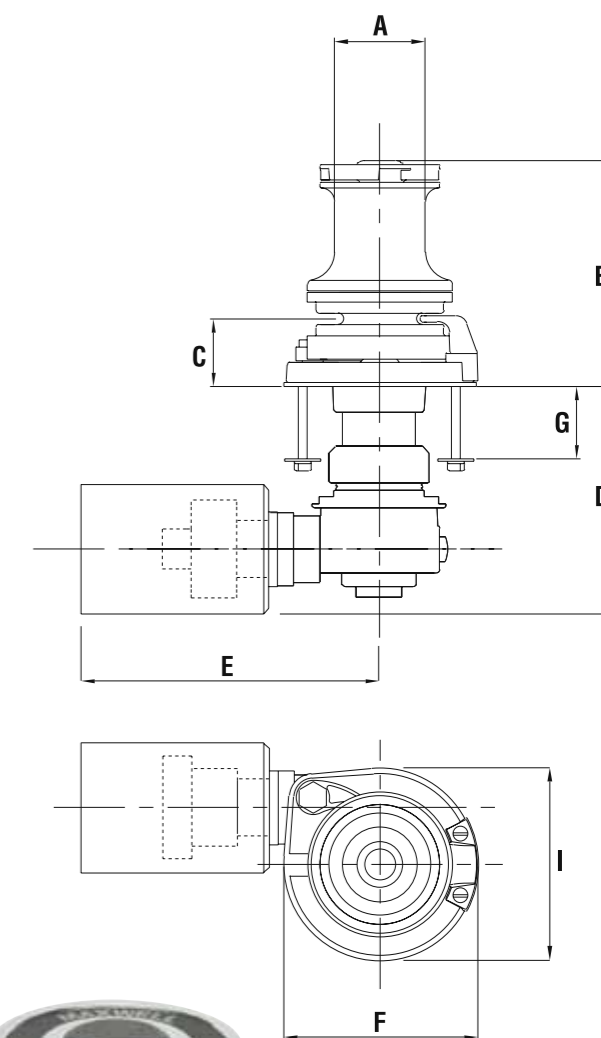

VW2500



MAX GRIP

NEW FOR 2012

The VW10 evolved from the demand for a vertical windlass that could be used in a horizontally installed configuration (refer image above), but which would also, interactively handle a rope/chain rode. The traditional VW models could be used with chain only rodes. The VW 10, capable of handling up to 10mm (3/8") chain and 16mm (5/8") rope is ideally suited for use in sailing boat anchor lockers, where space considerations are critical. Quick and easy to install and available with our without independant warping capstan, the VW10 is destined to become an instant hit in this unique niche market.



Design concept image