

ABA Original 12 mm 316 Stainless Steel Clamp

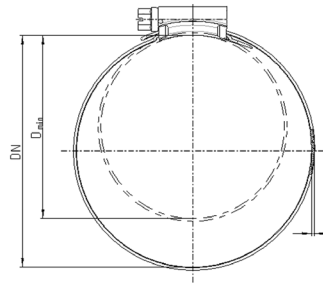

Bulk # Bags of 50	Boxed # Boxes of 10	SAE Size	Clamping Range		Tightening Torque Inch - Lbs.
			Inches	mm	
13024	13624	8	5/8 - 1	15 - 24	35 - 45
13028	13628	10	3/4 - 1 1/8	19 - 28	
13032	13632	12	7/8 - 1 1/4	22 - 32	
13038	13638	16	1 1/16 - 1 1/2	26 - 38	
13044	13644	20	1 1/4 - 1 3/4	32 - 44	45 - 60
13050	13650	24	1 1/2 - 2	38 - 50	
66057	13657	28	1 1/4 - 2 1/4	32 - 57	
66064	13664	32	1 1/2 - 2 1/2	38 - 64	
66070	13670	36	1 3/4 - 2 3/4	44 - 70	
66076	13676	40	2 - 3	51 - 76	
66083	13683	44	2 1/4 - 3 1/4	57 - 83	
66089	13689	48	2 1/2 - 3 1/2	64 - 89	
66095	13694	52	2 3/4 - 3 3/4	70 - 95	
66102	13696	56	3 - 4	76 - 102	
66108	13697	60	3 1/4 - 4 1/4	83 - 108	
66114	13698	64	3 1/2 - 4 1/2	89 - 114	
66127	13699	72	3 1/2 - 5	89 - 127	
66140	n/a	80	4 - 5 1/2	102 - 140	
66152	n/a	88	4 1/2 - 6	114 - 152	
66165	n/a	96	5 - 6 1/2	127 - 165	
66178	n/a	104	5 1/2 - 7	140 - 178	
66191	n/a	112	6 - 7 1/2	152 - 191	
66203	n/a	120	6 1/2 - 8	165 - 203	
66216	n/a	128	7 - 8 1/2	178 - 216	
66232	n/a	138	7 5/8 - 9 1/8	194 - 232	
66257	n/a	154	8 5/8 - 10 1/8	219 - 257	
66283	n/a	170	9 5/8 - 11 1/8	244 - 283	
66308	n/a	186	10 5/8 - 12 1/8	270 - 308	

ABA Hose Clamp