

ITEM NO.	DESCRIPTION	QTY.
1	KYMETA PLATE	1
2	2.125" SPACER	4
3	FLANGE	1
4	GROMMET	1
5	O-RING	1
6	5/16"-18 X 1.25" SCREW	8
7	M10 WASHER	4
8	M10 X 90MM SCREW	4

1. MAKE SURE ITEM (5) (O-RING) IS IN THE O-RING GROOVE ON THE BOTTOM OF ITEM (3).
2. ALIGN ITEM (3) (FLANGE) TO ITEM (1) (PLATE) AS SHOWN. USING ITEM (6) (5/16"-18 SCREWS) BOLT ITEM (3) AND ITEM (1) INTO SEAVIEW PEDESTAL (**TORQUE: 8-10 FT-LBF**).
3. ROUTE POWER/DATA/ADMIN CABLES, ENSURING THAT ITEM (4) (GROMMET) IS SECURED TO ITEM (3) (FLANGE).
4. ALIGN ANTENNA WITH THE 4 MOUNTING HOLES IN ITEM (1) AND SECURE WITH ITEMS (2) (SPACERS), (7) (WASHERS), AND (8) (M10 SCREWS) AS SHOWN. (**TORQUE: 25 FT-LBF**)

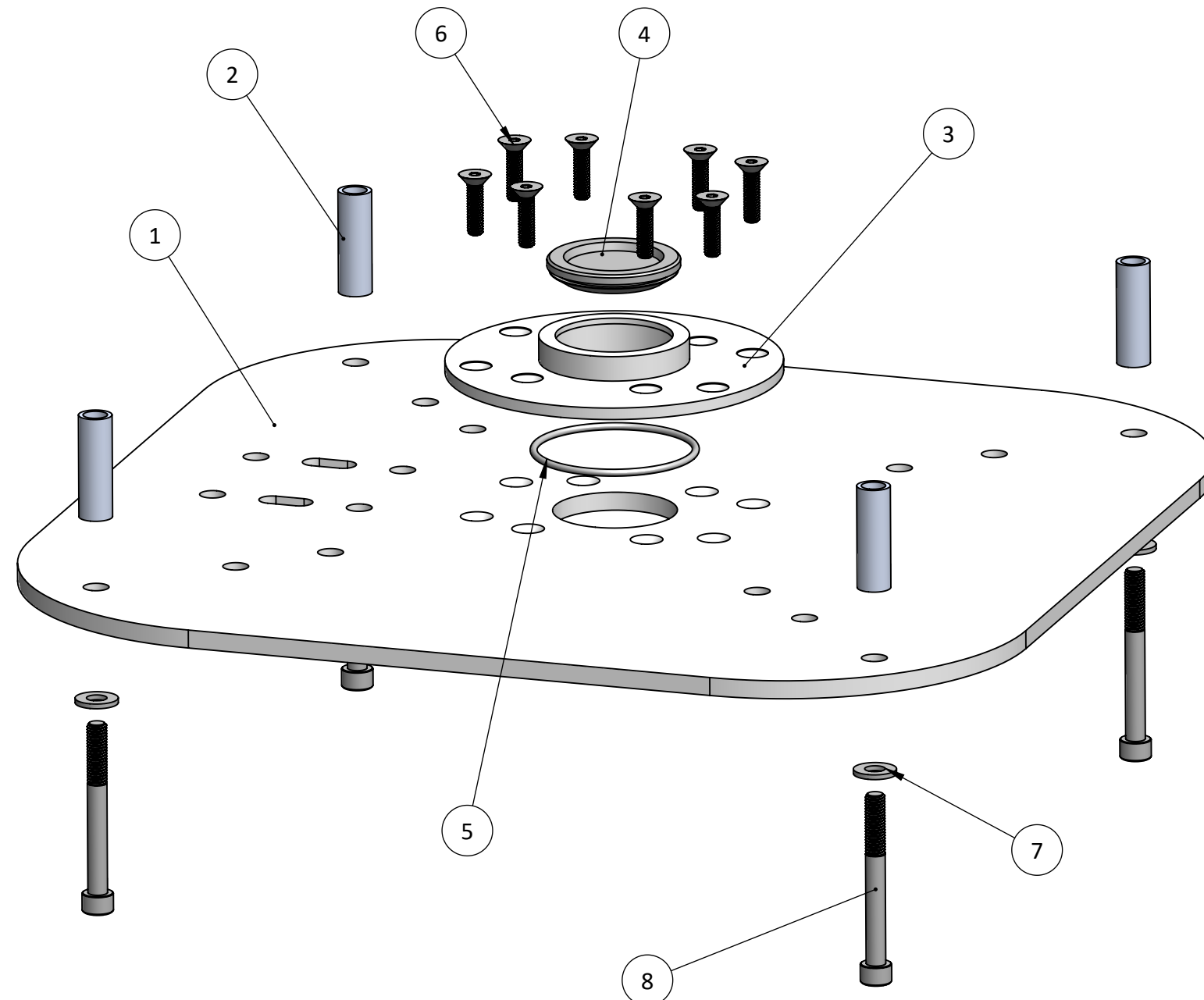

ADAKYMETA2

Due to the size and weight of the Kymeta Peregrine antenna, the ADAKYMETA2 plate is only to be used with the following Seaview pedestal mounts: PMA57M1, PMF57M1, PMA1210M2, PMA1810M2, PMADM1M2 & PMADM2M2. Contact Seaview if a different pedestal is needed.

For help e-mail
info@seaviewglobal.com
 ph. 1-800-655-7922

