

ITEM NO.	PART NUMBER	DESCRIPTION	QTY.
1	FLBBASE	MOUNTING BASE	1
2	FLBTOP	LIGHT BAR HOLDER	1
3	FLBGSKT	BASE GASKET	1
4	CG2R03	LARGE ROUND CS PLUG	1
5	FLBBSHB	STEPPED BUSHING	2
6	SVCAMLEV	HANDLE	1
7	SVCAMTHRDINS.25	1/4"-20 THREADED INSERT	1
8	SP12	NYLON SHOULDER BUSHING	6
9	SVCAMRSSWASHER	THRUST WASHER	1
10	FLBCSPRG	COMPRESSION SPRING	1
11	1420LNUT	1/4"-20 NYLOC NUT LOW PROFILE	2
12	14202BHCS	1/4"-20 X 2" BHCS	2
13	14SSW	SS WASHER FOR 1/4" BOLTS	7
14	14NW	NYLON WASHER FOR 1/4" BOLTS	1
15	SVFLT12 / SVFLT24 / SVFLT36 (NOT SHOWN)	LIGHT POST (NOT SHOWN)	1
16	1420238HCS	1/4"-20 X 2.375" PATCHED HEX HEAD SCREW	1
17	LTBLED12 (NOT SHOWN)	ROUND SEAVIEW 3NM LED COMBINATION MAST HEAD ALL-AROUND LIGHT (NOT SHOWN)	1

SVMHB1##LEDSS#

- Notes:
- Please note that some dimensions may not be shown (applies to all pages)
 - Do not scale drawing. (applies to all pages)
 - Some views may be broken or cropped to improve clarity (applies to all pages)
 - For help, e-mail info@seaviewglobal.com; ph. 1-800-655-7922.

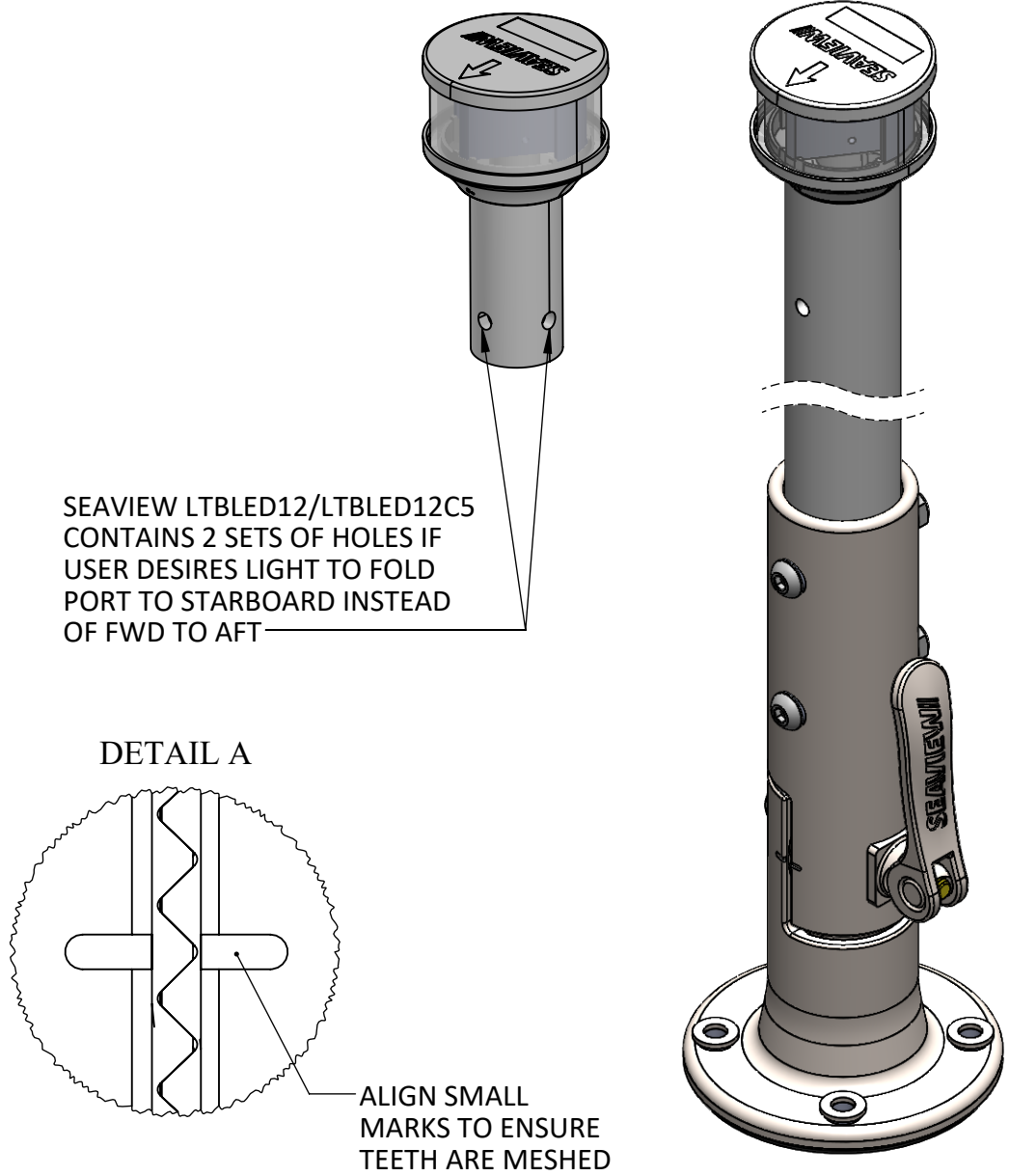
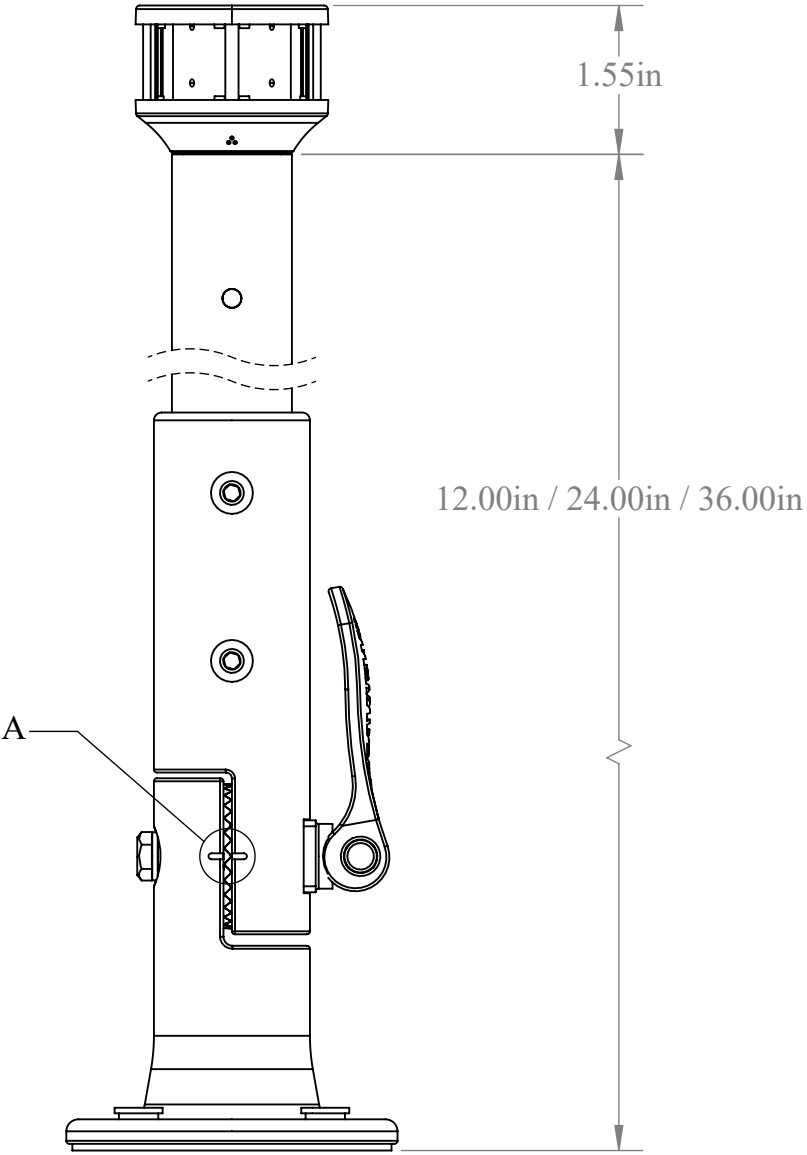
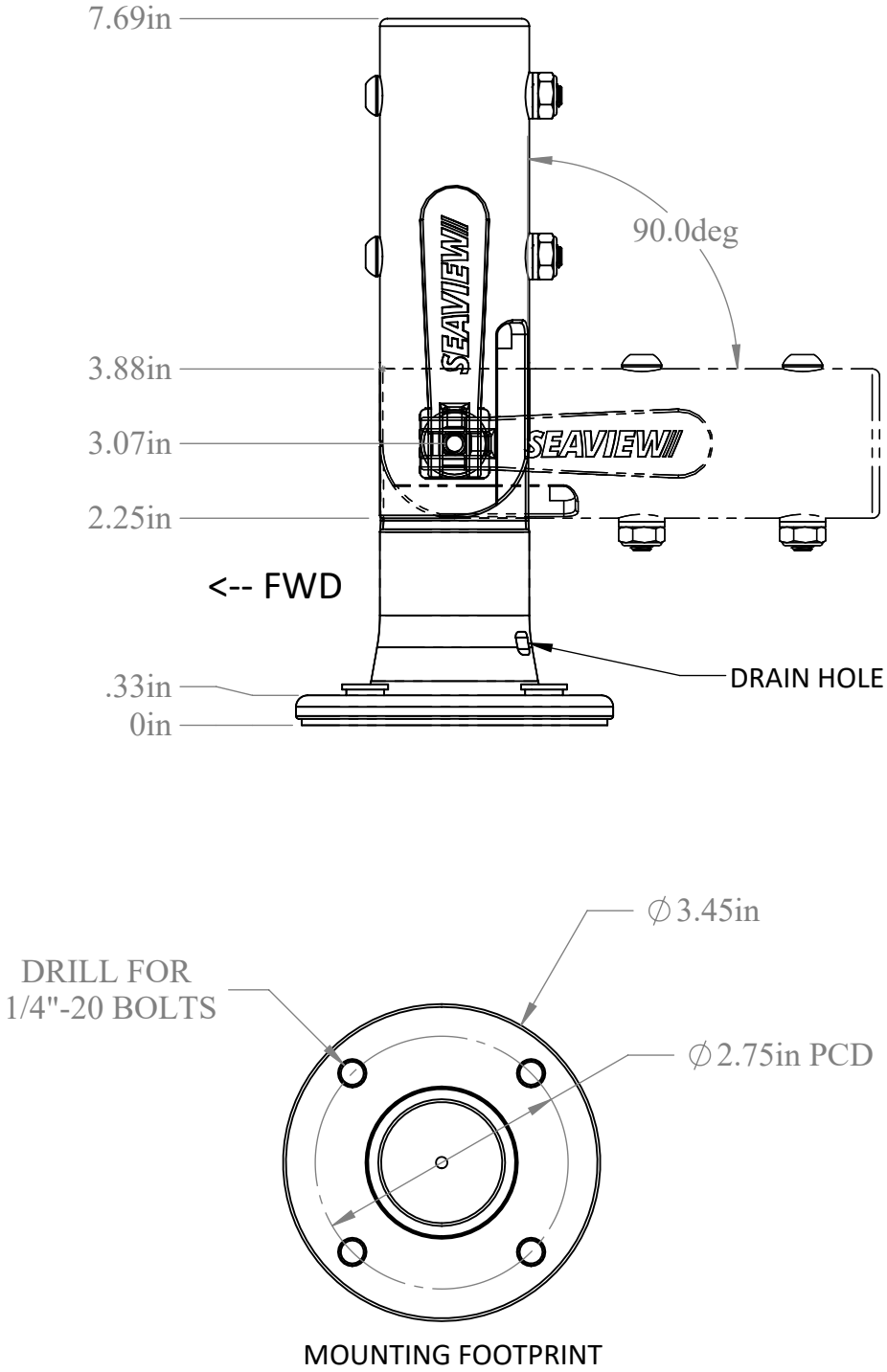

SVMHB1##LEDSS#

For help e-mail
info@seaviewglobal.com
ph. 1-800-655-7922

***INSTALLATION INSTRUCTIONS
BEGIN ON NEXT PAGE***

1 Using the provided base gasket (item **3**), mark and drill holes. Note the forward direction below.

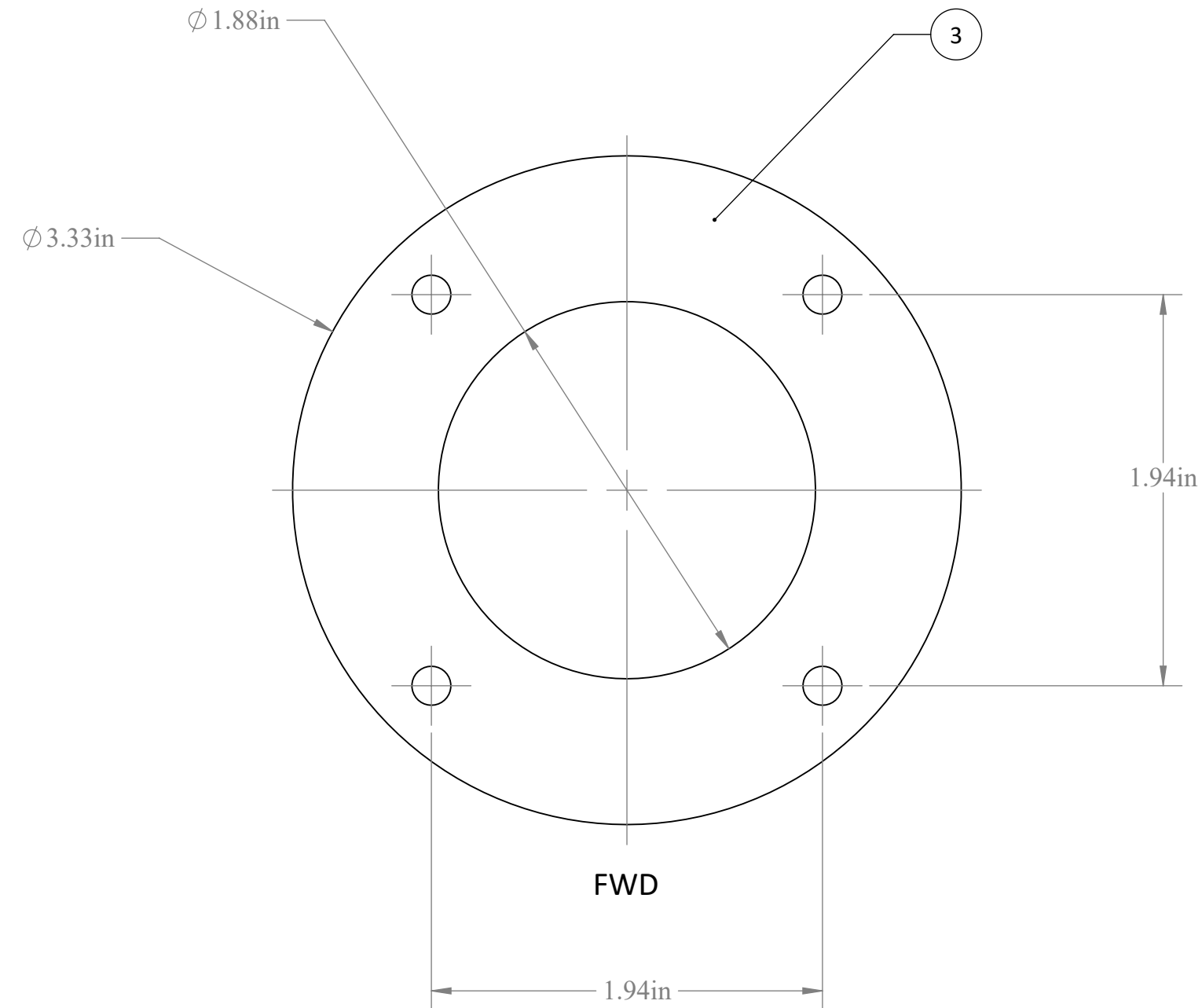

For help e-mail
info@seaviewglobal.com
ph. 1-800-655-7922

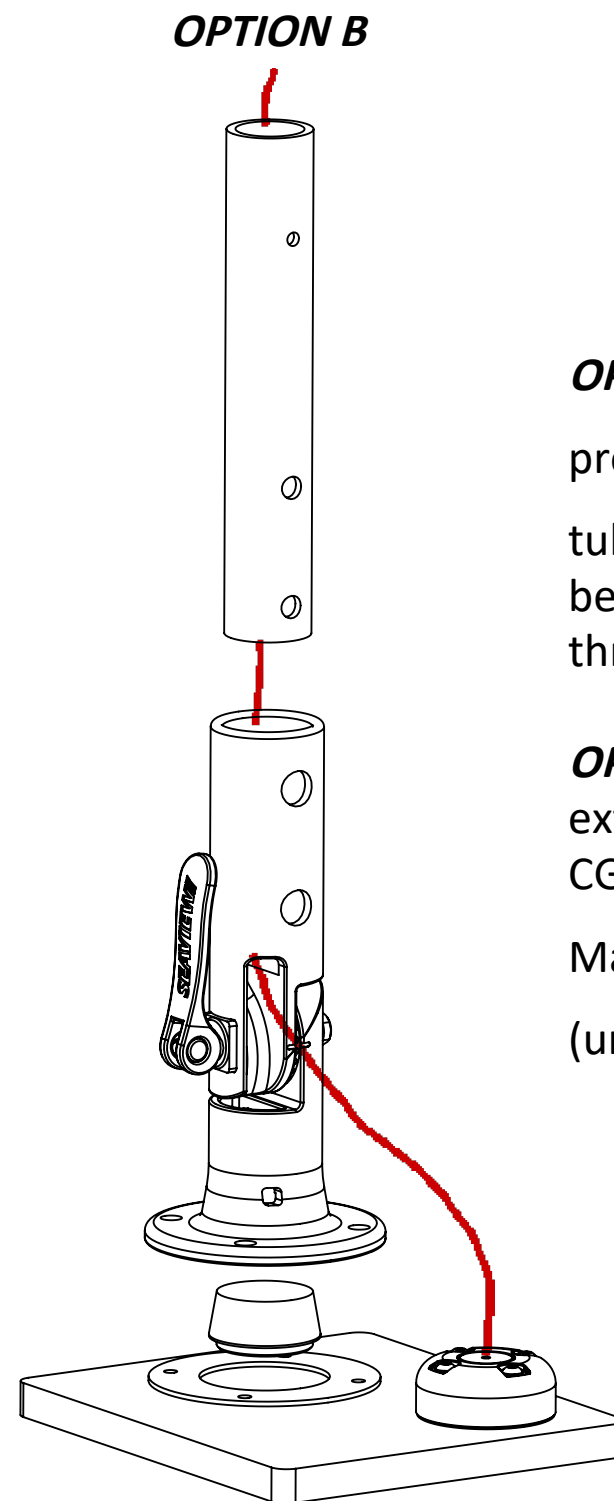
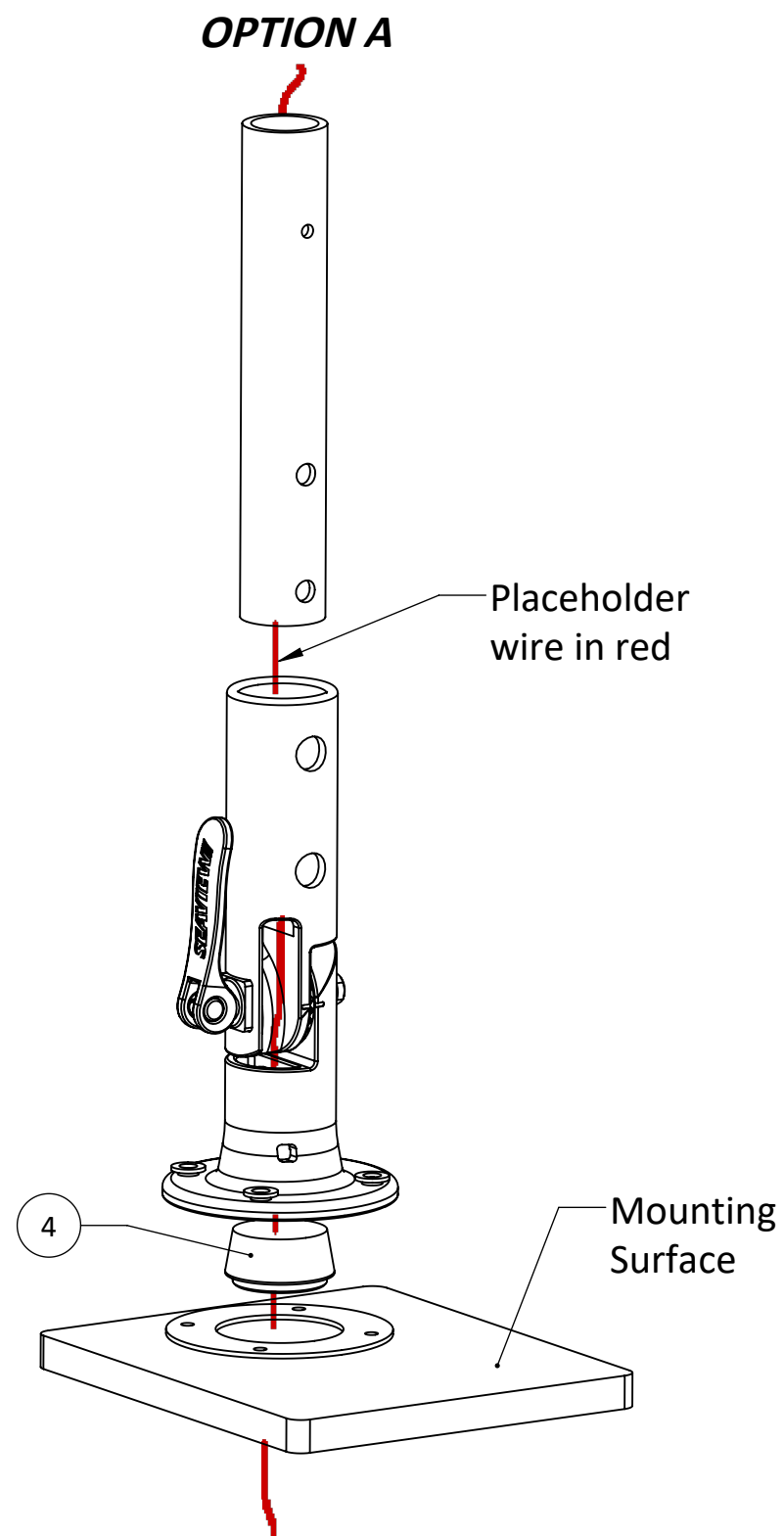

OPTION A: When using the LTBLED12/LTBLED12C5, drill the provided rubber bung (item 4) with the provided 7mm drill tube. If using a different light brand or routing multiple light wires, be sure to follow page 1 found [here](#). Make sure the wire is routed through all necessary components before moving to the next step.

OPTION B: Alternatively, you may choose to route the wire/wires externally. We recommend using Seaview cable seal part number CG20SS or CG30SS, which will match the polished stainless base. Make sure that the rubber bung (item 4) is still inserted (undrilled) as shown to the left so water properly drains.

3 Install the LTBLED12 into the light post following steps 1-3 [here](#).

SEAVIEW

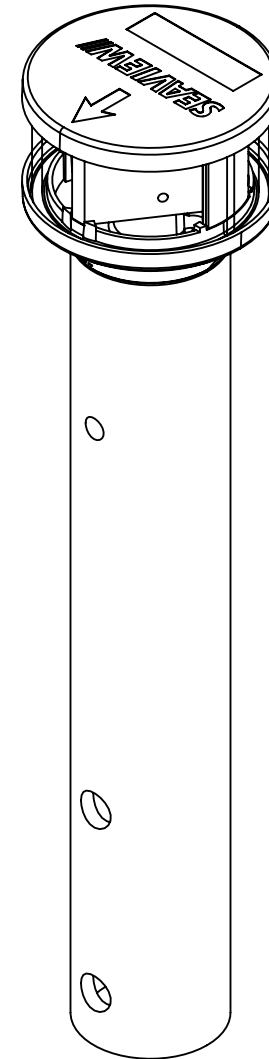
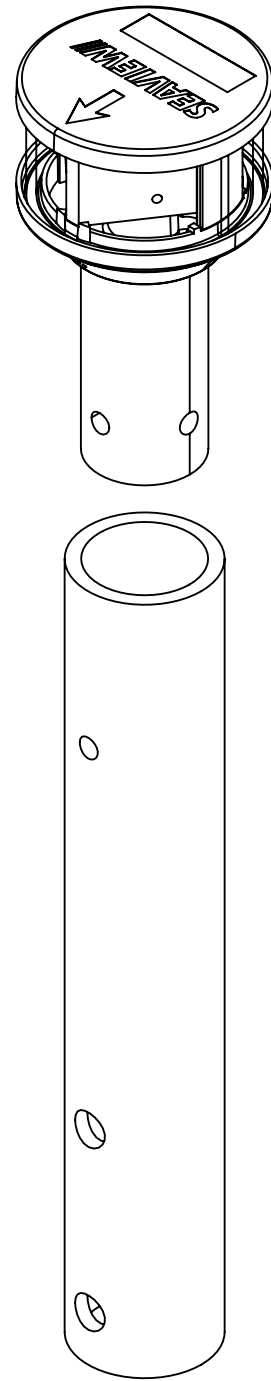

For help e-mail
info@seaviewglobal.com
ph. 1-800-655-7922

4 Before installing the light post into the stainless steel receiver (item 2), it is recommended that sealant or Tef-Gel is applied to the bottom of the light post where it meets the receiver. Once sealant or Tef-Gel is applied, secure the light post to the stainless steel receiver using items 5, 8, 11, 12, & 13.

SEAVIEW

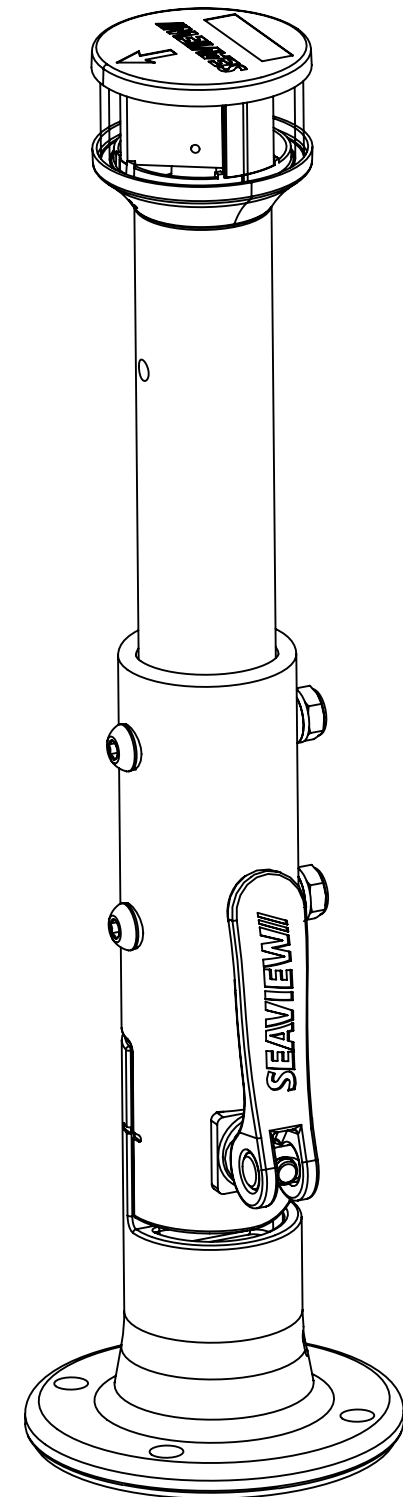
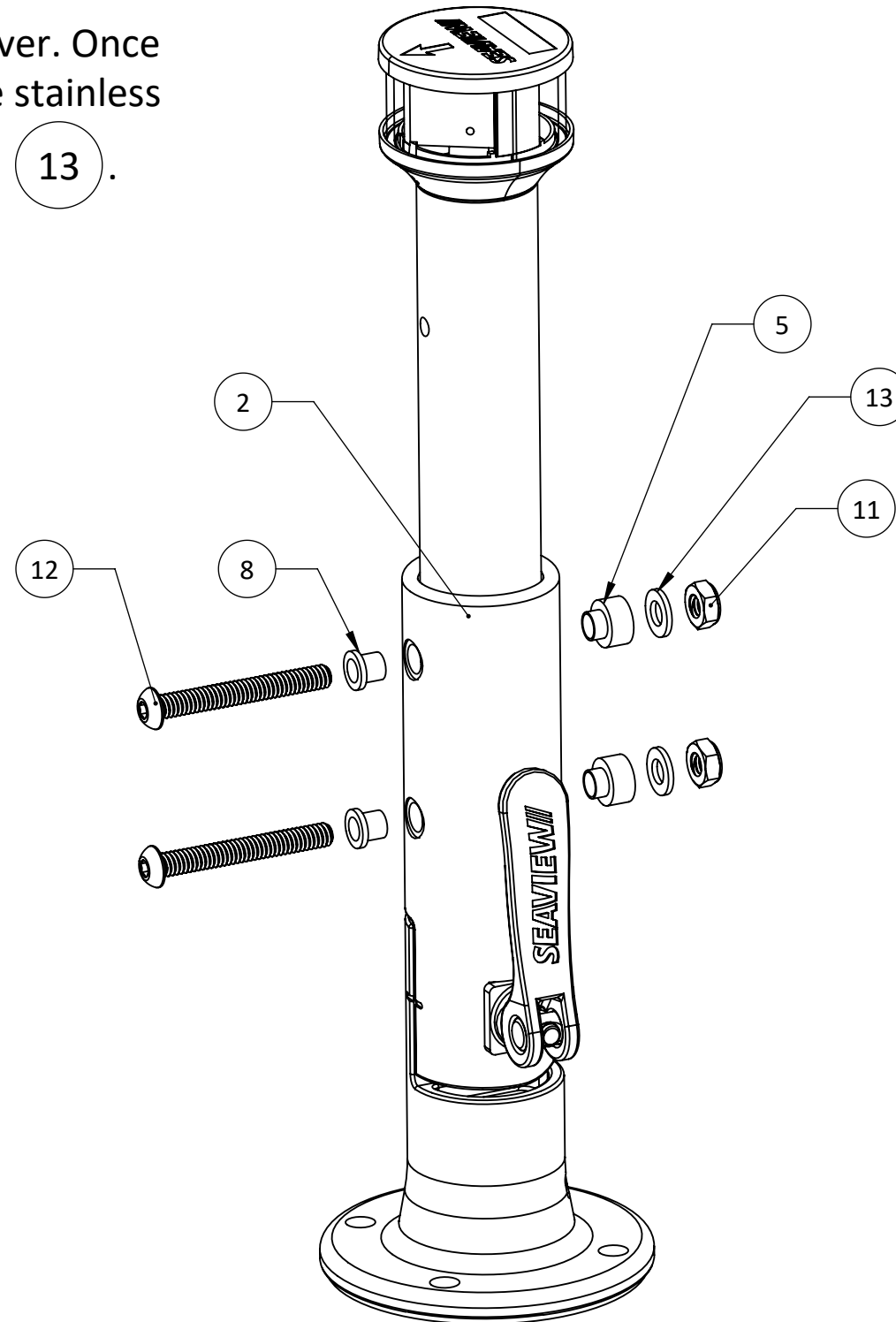
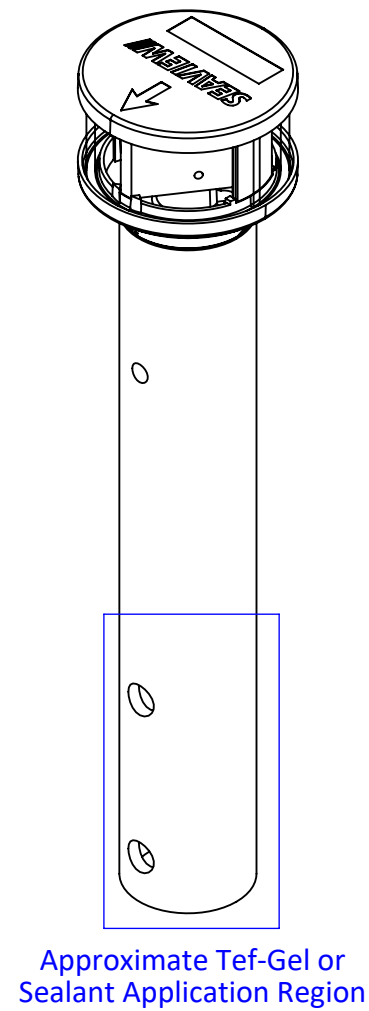

For help e-mail
info@seaviewglobal.com
ph. 1-800-655-7922

5 With the wires correctly routed from step 2, and the light + light post installed from steps 3-4, secure the complete assembly to the mounting surface using nyloc nuts (or similar). Due to varying mounting surface types and thicknesses, ensure the correct mounting bolts and hardware are used.

SEAVIEW

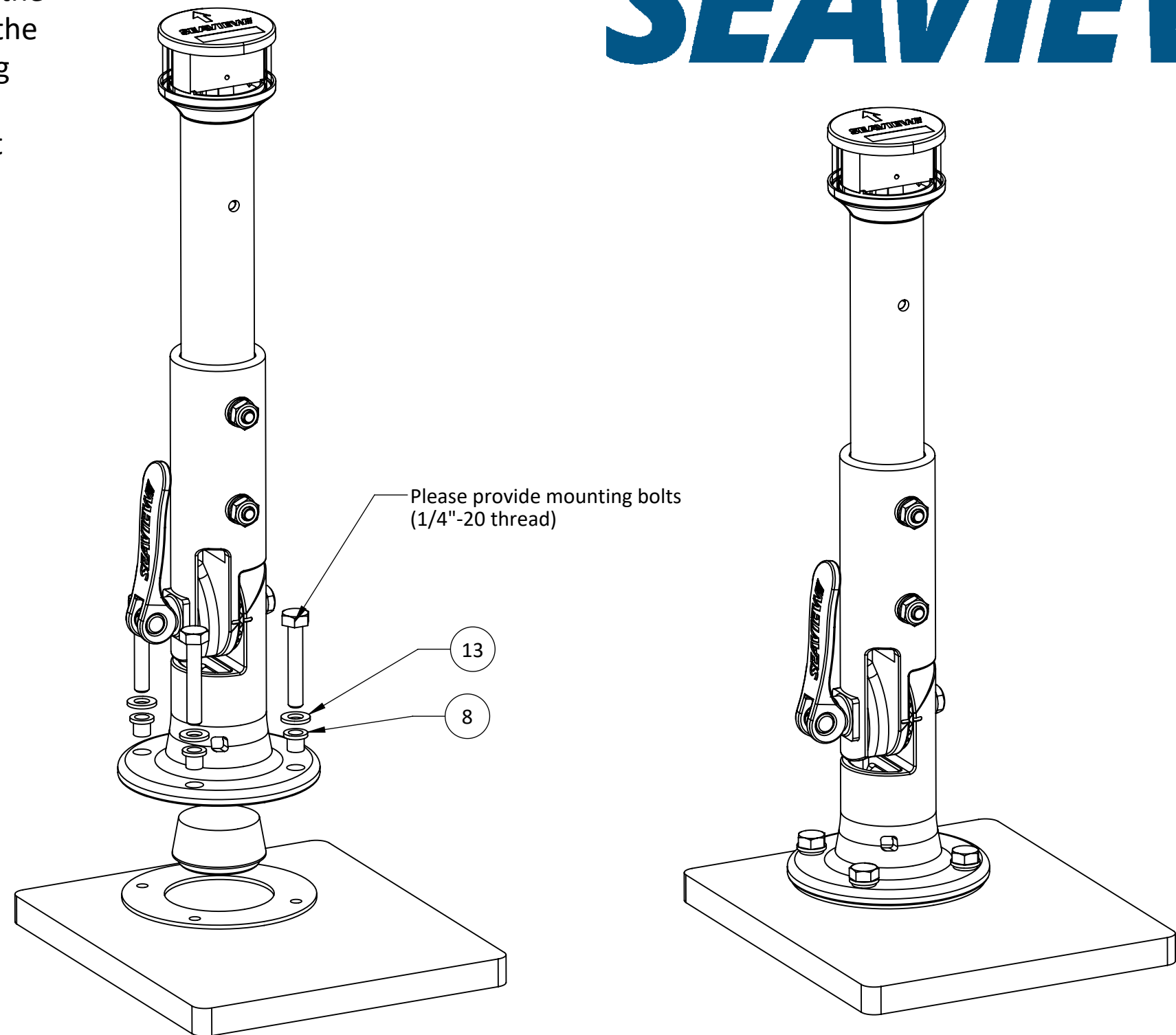

For help e-mail
info@seaviewglobal.com
ph. 1-800-655-7922

6

To operate the folding light post, simply unclamp the cam lever, fold, and then reclamp. The cam lever will follow the rotation of the light post due to the square thrust washer. Be sure to hold the post as it folds since there are no dampers to prevent it from falling onto the mounting surface.

SEAVIEW

The base is preset to a clamping force of 12-13 in-lb in order to make the fold action quick and easy. The hex bolt is also equipped with a pre-applied yellow thread lock patch. It is possible that over time the clamping force could be reduced, requiring an adjustment on the hex head screw torque. Simply acquire a 7/16" socket (or similar), clamp the handle down as shown in **B**, and tighten the hex head to 12-13 in-lb or greater. It is recommended that blue Loctite (or similar) is used when reapplying torque to the hex head bolt on the other side of the cam lever (see detail E).

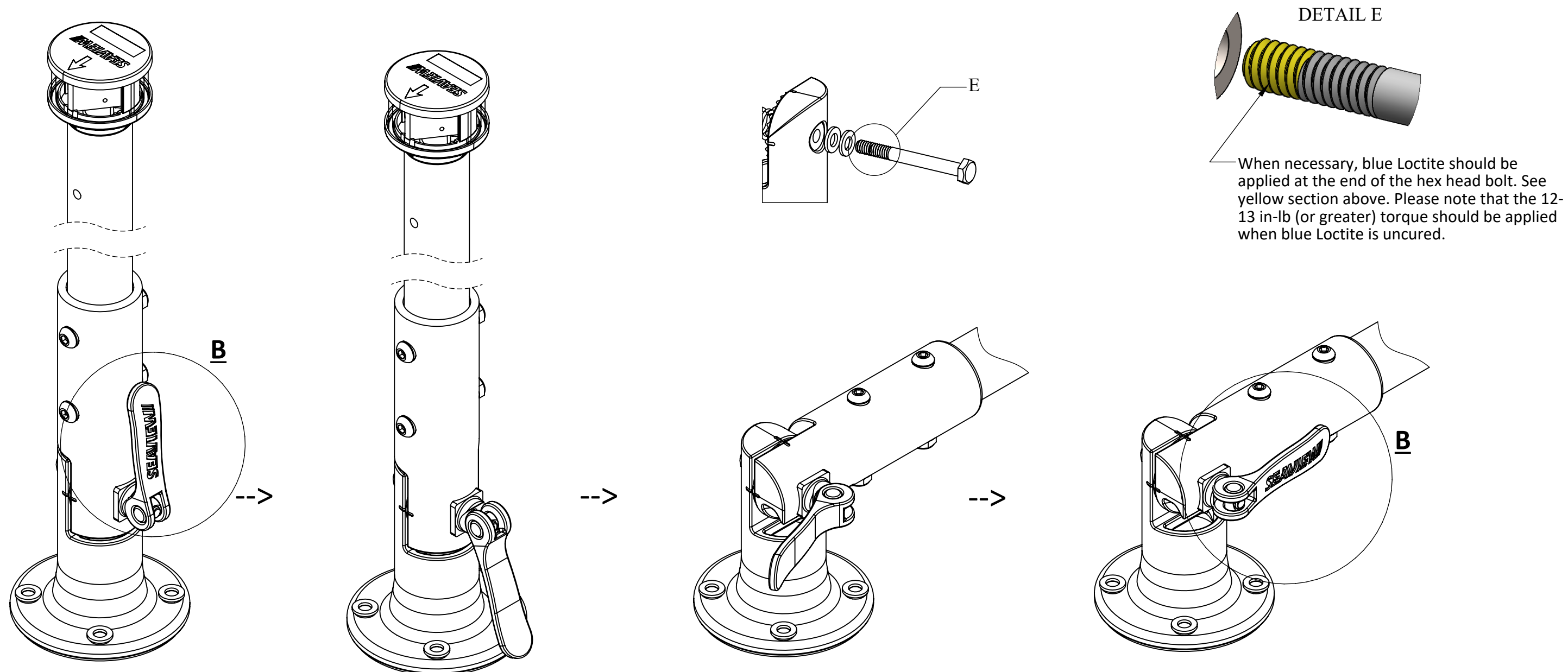

For help e-mail
info@seaviewglobal.com
 ph. 1-800-655-7922

7 Optional: During torque readjustment as outlined in the previous step, a user may wish to rotate the cam handle sideways to make it easier to grab ahold of. If needed, apply more grease between the cam handle and thrust washer. Super Lube multi-purpose synthetic grease is pre-applied.

SEAVIEW

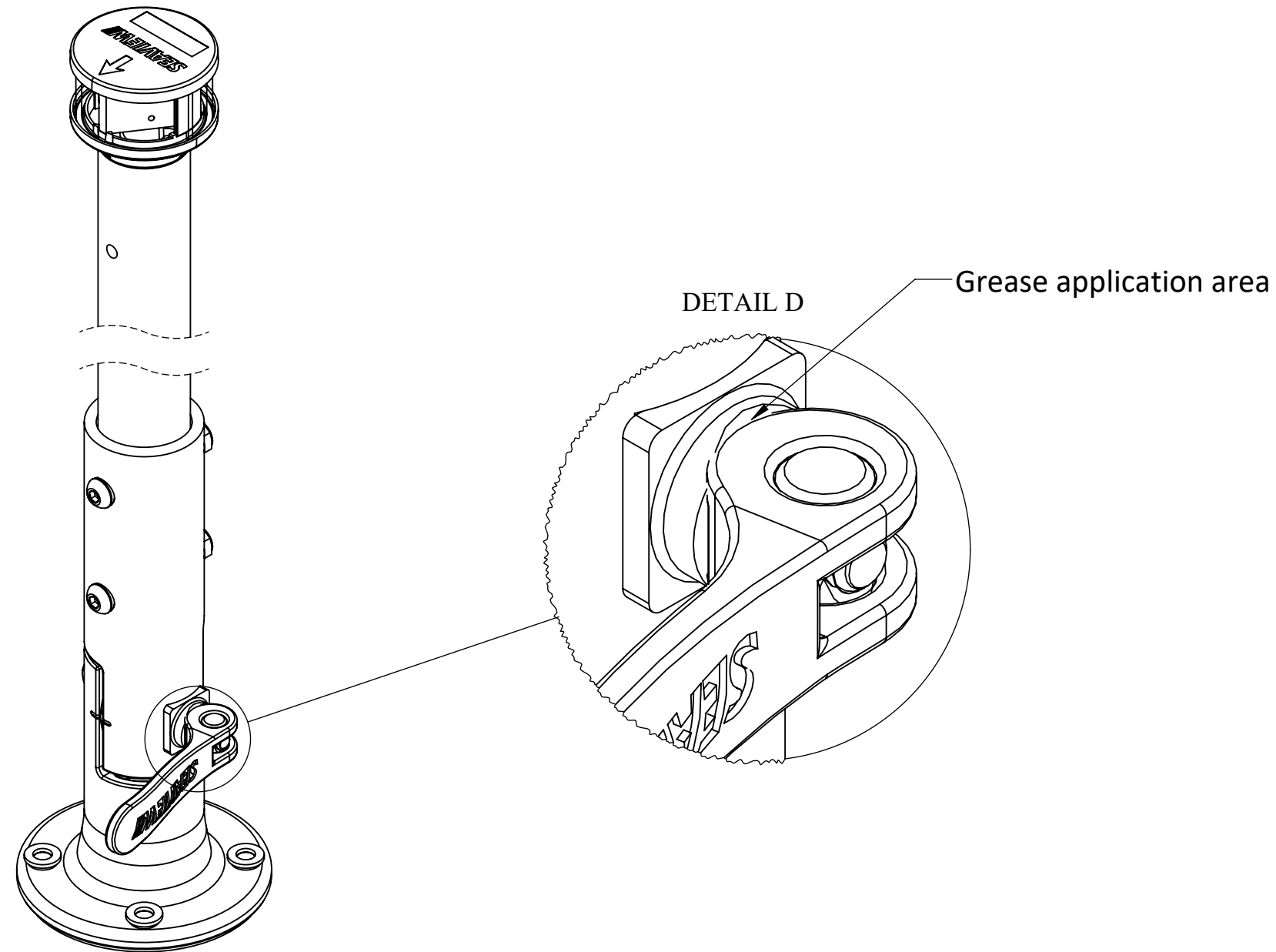

For help e-mail
info@seaviewglobal.com
ph. 1-800-655-7922

8 LED light installation info found [here](#).

SEAVIEW

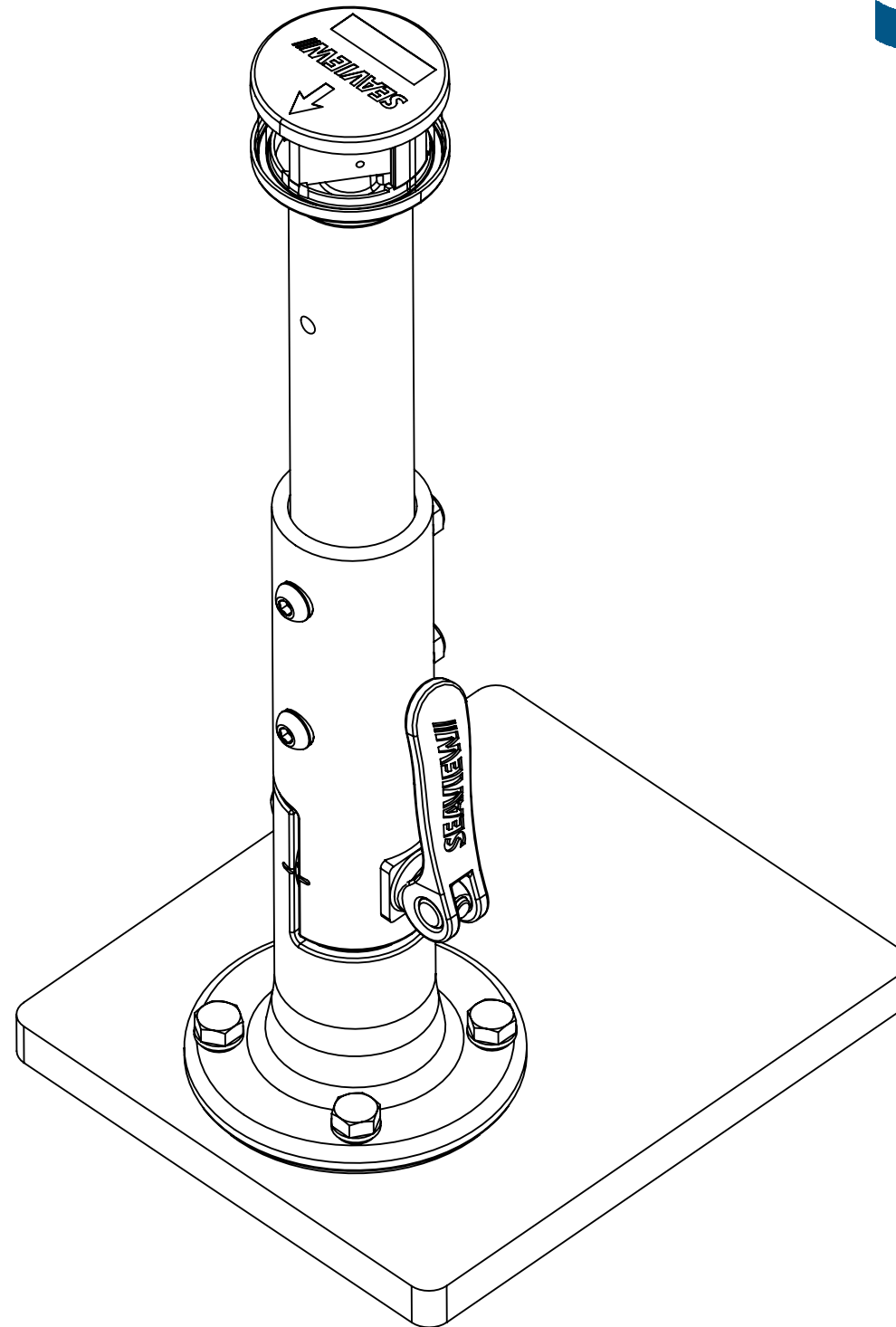

For help e-mail
info@seaviewglobal.com
ph. 1-800-655-7922