

75/90/115 Hp (2065cc), 150 Hp (3000cc) & 2015-17 6-Cylinder Verado Motors

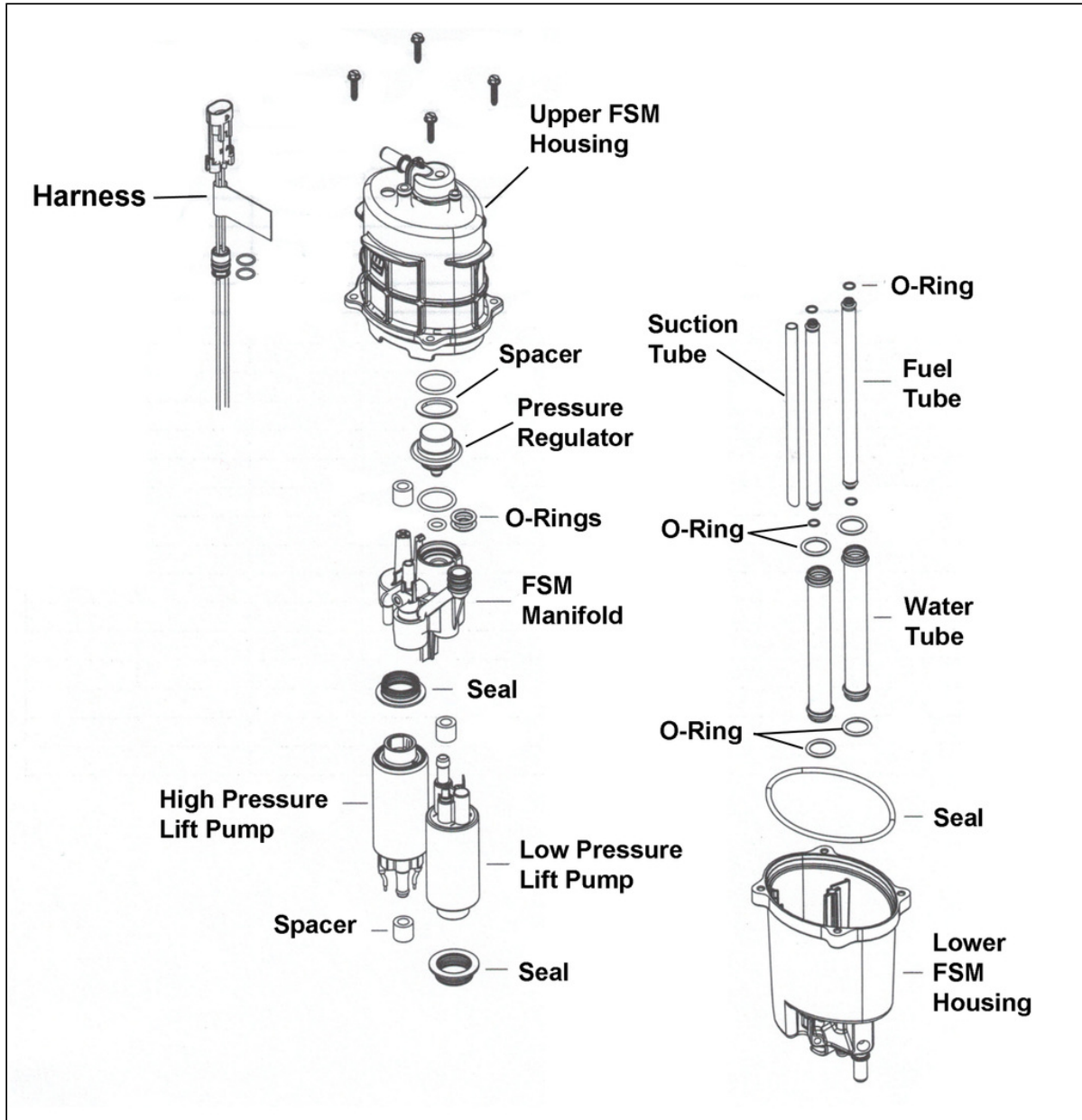

Exploded view of the FSM assembly - 75-115 hp (2065cc), 150 Hp (3000cc) & 2015-17 6-cylinder Verado motors

1. Remove the FSM from the motor and place it in a flat container. You cannot remove all of the fuel from the module so you need something to catch any captured fuel.
2. Remove the 4 screws connecting the upper and lower module housings. Pull the upper housing up just enough to insert 2 small prybars into the gap and then use them to carefully separate the 2 housings. Be careful you do not scratch any of the internal components.

Remember that the lower housing maybe full of fuel!

3. Once the upper housing is off, carefully tag and disconnect the pump power wires and lay the housing down. Remove the O-ring from the lower housing.
4. In some cases, the manifold may come off of the lower housing components with the upper housing. If this is the case, grab the manifold webbing with vice grips and pull it out of the upper housing. Otherwise, lift the manifold carefully up and off of the fuel pumps and tubes.
5. Carefully lift out the fuel pumps and water/fuel tubes. If the fuel pumps are sticking in the housing, use an appropriate tool to help remove them. Take note though, DO NOT twist either of the pumps while removing them.
6. Remove the 2 fuel pump grommets from the bottom of the manifold. Now remove the 3 O-rings and spacer from the top side of the manifold.
7. Carefully spread the pressure regulator retainers just enough to remove the regulator. DO not spread them too much. Remove the O-ring and spacer from the top side of the regulator.
8. Check the inside of each housing for any grommets and remove them. Press the fuel pump power wire grommet through from the outside of the upper housing.

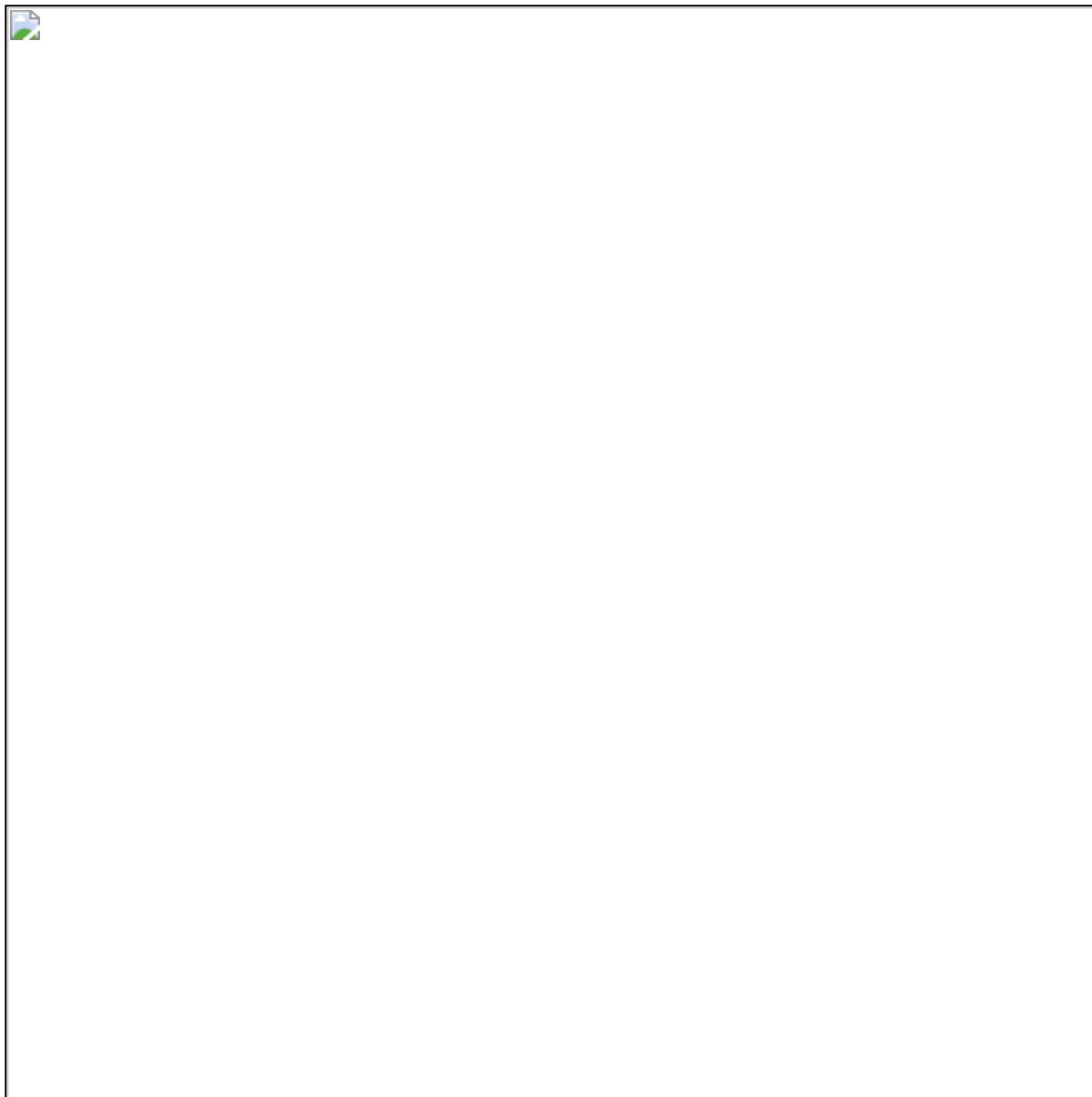
To Assemble:

Make sure the high pressure pump leads are routed between the water tube and manifold webbing

9. If removed, install the O-rings into the ends of each water and fuel tubes. Coat the O-rings lightly with 2-4-C w/PTFE and install fuel tubes into the lower housing. Position the water tubes over the fuel tubes and then slide them down and into the housing.
 10. Install the seal grommet half way onto the bottom of the high pressure pump. Coat the grommet lightly with 2-4-C w/PTFE and then install the pump into the lower housing so the electrical leads are between the manifold webbing and water tube.
 11. Install the seal grommet half way onto the bottom of the lift pump and coat lightly with 2-4-C w/PTFE. Install the pump into the lower housing so the outlet port faces toward the center of the housing.
 12. Now install the upper grommets for both pumps half way and coat with 2-4-C w/PTFE.
 13. Install 2 O-rings onto the top of the manifold. Check that there are no obstructions in the manifold tube hole opposite.
 14. Position the manifold over the tops of the pumps and water/fuel tubes. Once everything is lined up, install the manifold so it is seated on the pumps and tubes. Make sure that the electrical leads are not pinched or binding.
 15. Install the spacer onto the pressure regulator. Install the O-rings after coating them lightly with 2-4-C w/PTFE. Install regulator into the manifold and then install the upper spacer and O-ring.
 16. Install the seal grommet half way onto the manifold.
 17. Connect the Red wire connector to the positive terminal on the lift pump.
 18. Install the upper housing O-ring. Lubricate the 2 pump harness grommet O-rings lightly with 2-4-C w/PTFE and then install them onto the harness grommet making sure that the Blue O-ring is installed in the upper groove (the groove closest to the housing).
 19. Pull on the harness while pressing the grommet from the inside of the upper housing until it is fully seated.
 20. Connect the Red wire from the housing to the positive terminal on the lift pump and then do the same with the Black wire to the negative terminal. Now connect the Black wire from the high pressure pump to the terminal on the lift pump.
 21. Make sure that all visible grommets and O-rings have been coated lightly with 2-4-C w/PTFE and then install the upper housing over the lower housing making sure that none of the electrical leads are crimped or pinched. Tighten the 4 bolts to 89 inch lbs. (10 Nm).
- If the two housings will not seat fully, check that there is not a pinched wire or a grommet install incorrectly.***
22. Reconnect the high pressure hose and install the FSM.